



Werkstoffgruppe AISI 316  
Groupe de matériaux AISI 316  
AISI 316 material group

**Stab-/Seilverbinder**  
**Raccord barre/câble**  
**Rod/rope connector**

| Nr. / N° / No. | Nr. / N° / No. | Nr. / N° / No. | Nenngrösse<br>Designation<br>Size designation | Gewinde<br>Filetage<br>Thread | Abmessungen<br>Dimensions<br>Dimensions |    |      |      |
|----------------|----------------|----------------|---|-------------------------------|---|----|------|------|
|                |                |                | Ø   | a                             | b1                                      | b2 | Ø d1 | Ø d2 |
|                |                |                | mm  | mm                            | mm                                      | mm | mm   | mm   |
| 30921-1000-02  | 30921-1000-03  | 30921-0800     | 10  | M8                            | 18                                      | 13 | 20   | 10,5 |

Ø 10 mm M8 Nr. / N° / No. -1000-02

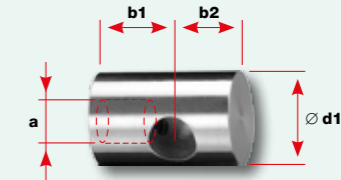

Ø 10 mm M8 Nr. / N° / No. -1000-03

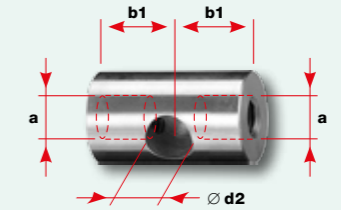

M8 Nr. / N° / No. -0800



Werkstoffgruppe AISI 316  
Groupe de matériaux AISI 316  
AISI 316 material group

**Stab-/Seilhalter**  
**Support pour barre/câble**  
**Rod/rope holder**

| Nr. / N° / No. | Ø  | a  | b1  | b2 | c  | Ø d1 | Ø d2 | Ø d3 | Ø d4 |
|----------------|----|----|-----|----|----|------|------|------|------|
|                | mm | mm | mm  | mm | mm | mm   | mm   | mm   | mm   |
| 30921-1000-04  | 10 | M8 | 116 | 18 | 13 | 20   | 10,5 | 8,5  | 20   |

Ø 10 mm M8

